

GREEN BOILER TECHNOLOGIES

A2000 SERIES WATER HEATER

TYPICAL SPECIFICATION

Water heater shall be Green Boiler Technologies, model number _____ having a recovery of _____ gallons per hour at a 100° F temperature rise with an input rating of _____ BTU/HR, and shall be operated on natural or propane gas.

The heat exchanger waterway will be non-ferrous, helically wound in an hourglass continuous coil. The water containing sections shall be of 1 ¼" I.D. copper-fin tube construction having extruded integral fins spaced 7 fins per inch. The tubes shall be brazed to an all bronze inlet/outlet. The heat exchanger shall be built in accordance with ASME Section IV, designed for a working pressure of 160 PSIG and bear the "H" stamp. The entire heat exchanger shall carry a 10-year limited warranty, and a lifetime warranty against the effects of thermal shock.

The atmospheric burner shall be constructed of cast iron with multiple bronze orifice jets combined to form one "Turbulated Combustion Efficient Flame." The burner shall operate on natural or propane gas. The unit shall include a gas pressure regulator and Standard or 2-Stage gas train.

The entire unit will be factory assembled with stainless steel exterior jacketing, wired and factory fire tested. Heater shall be furnished with IID (intermittent pilot burner ignition system) with 90 second or less shut-off response to pilot failure. Heater shall be equipped with a manual reset high limit aquastat.

Water heater shall be third party certified and approved as a Category I appliance using type B vent material.

GREEN BOILER TECHNOLOGIES

A2000 SERIES WATER HEATER

SUBMITTAL

JOB NAME _____

LOCATION _____

ARCH./ENGR. _____

WHOLESALE/REP. _____

MECH. CONTRACTOR _____

TAG: _____

MODEL NO. _____ BTU INPUT _____ RECOVERY _____ TYPE GAS _____

OPTIONAL EQUIPMENT _____

STANDARD EQUIPMENT

Hourglass copper fin tube heat exchanger

Electronic spark ignition

24-volt control system

Cast iron burner w/ bronze orifices

ASME 125# pressure relief valve

Manually operated gas cock

Manual reset high limit aquastat

Enclosed control panel

24-volt main gas valve

Draft hood

Drain cock

Gas pressure regulator

Bronze inlet & outlet manifold

ASME 160# design pressure

Stainless steel exterior jacket

OPTIONAL EQUIPMENT

Circulating pump

Pump delay

2-Stage gas train

Flow switch

Thermometer

T & P dial gauge

Low water cut-off

GREEN BOILER TECHNOLOGIES

A2000 SERIES WATER HEATERS

DIMENSIONS AND SPECIFICATIONS

MODEL	BTU INPUT	GPH REC @ 100°F RISE	GAS CONN	WATER CONN	VENT	PUMP	SHIPPING WEIGHT
A2H035	350,000	336	1"	1 1/2"	9"	1/9 HP	460#
A2H050	500,000	480	1"	1 1/2"	10"	1/9 HP	600#
A2H070	700,000	672	1 1/4"	1 1/2"	12"	1/2 HP	650#
A2H097	970,000	932	1 1/4"	1 1/2"	16"	1 HP	700#
A2H120	1,200,000	1152	1 1/2"	1 1/2"	16"	1 1/2 HP	804#
A2H140	1,400,000	1345	1 1/2"	1 1/2"	18"	1 1/2 HP	944#

MODEL	A	B	C	D	E	F	G	H	K
A2H035	7	17 1/2	34 1/2	38	58	9	24	10	29
A2H050	8	16 1/2	33	42	69	10	28	18 1/2	33
A2H070	10 1/4	13 1/4	33	38 3/4	66	12	32	25	36 1/4
A2H097	6 3/4	17 3/4	38	41 1/4	77 1/4	16	35	20	43
A2H120	7	17 1/2	44 1/2	48 1/2	84 1/2	16	35	22	43
A2H140	7	17 1/2	44 1/2	48 1/2	100 1/2	18	35	22	43

NOTES:

1. Pump capacity based on heater to tank circulating loop of not more than 45' of pipe & fittings.
2. Dimensions are for units with standard gas trains.
3. All dimensions are in inches.

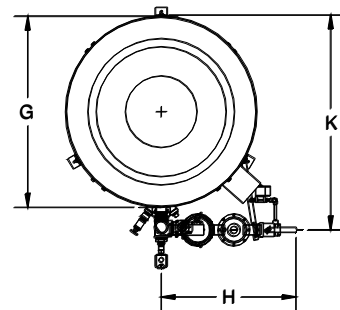
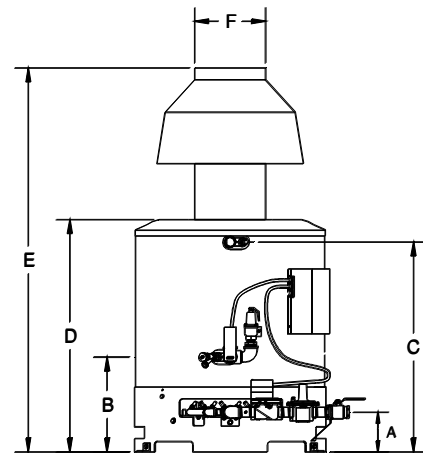

ASME Section IV, Water
Heater Code 160 PSI working
Pressure and National Board
Registered.